

# Justice in Motion 5K

Jonesborough, Tennessee

Measured by Lynwood Wagner 3/29/2015  
onjwagner@hotmail.com 423-282-5559

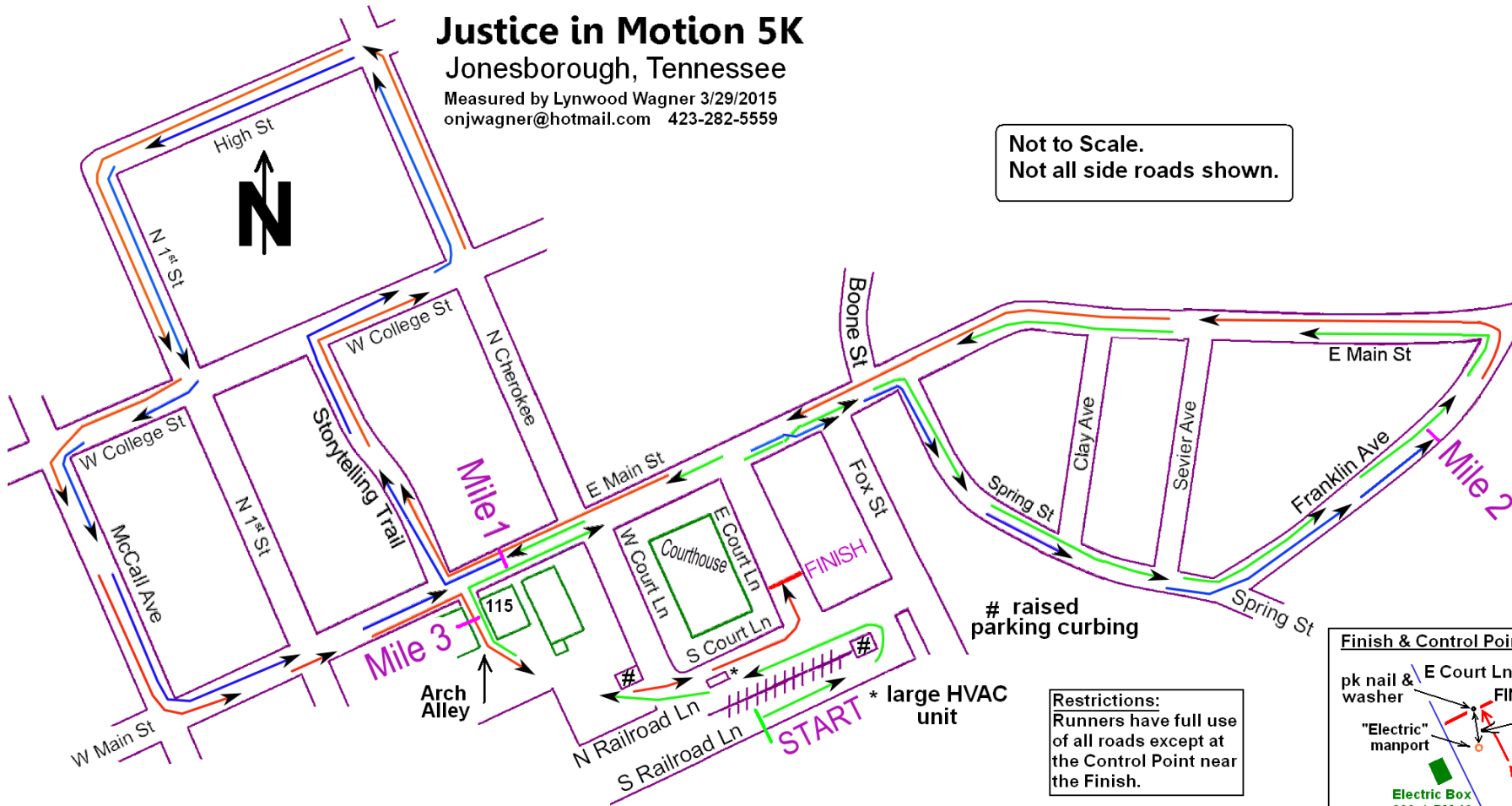

Not to Scale.  
Not all side roads shown.

# raised parking curbing

\* large HVAC unit

Restrictions:  
Runners have full use of all roads except at the Control Point near the Finish.

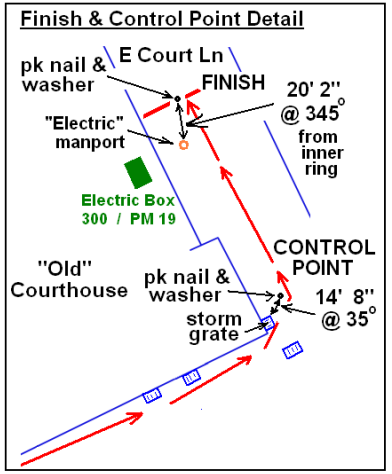
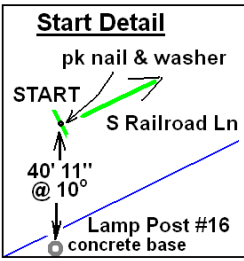

**Justice In Motion 5K Markers**  
All marked by paint over pk nails & washers except Mile 1 which is paint only.

**Start:** S Railroad Lane 40' 11" @ 10° from concrete base of LP P16.

**Mile 1:** Even w/ manhole in W Main in front of "The Chester Inn."

**Mile 2:** W edge of Franklin Avenue near E Main 63' 11" @ 255° from "McKinney Center" sign base.

**Mile 3:** In Arch Alley 6' south of large, green electric box #150.

**Control Point 1:** In E. Court Lane 14' 8" @ 35° from NE corner of storm grate @ SE corner of Courthouse.

**Finish:** In E Court Lane 20' 2" @ 345° from inner ring of "Electric" manport even w/ large green electric box #300 / PM 19.